

INSTRUCTIONS:

1. TURN OFF (OPEN) AC INPUT CIRCUIT BREAKER (CB1), AND DC OUTPUT CIRCUIT BREAKER (CB2).
2. ALLOW INTERNAL VOLTAGES TO DISSIPATE.
3. OPEN DOOR PANEL, AND CAREFULLY REMOVE PLEXIGLASS SHIELDS.
4. USING A VOLTMETER, VERIFY ALL POTENTIAL VOLTAGES IN CHARGER ARE AT "0".
5. LOCATE ELIMINATOR CAPACITOR (C2) MOUNTED TO LEFT REAR OF BASE.
6. REMOVE WIRE "C2-" AND "C2+" FROM A2 POWER BOARD.
7. CLIP ZIP TIES AND REMOVE C2 ASSEMBLY FROM CHASSIS.
8. REMOVE RESIDUAL DOUBLE SIDED TAPE FROM CHASSIS.
9. PEEL DOUBLE SIDED TAPE FILM FROM BOTTOM OF CAPACITOR.
10. PLACE REPLACEMENT CAP ASSEMBLY ON CHASSIS, CENTERING WITHIN CHASSIS LANCES.
11. REPLACE ZIP TIES AS SHOWN.
12. REPLACE WIRE C2- AND C2+ AS SHOWN BELOW.

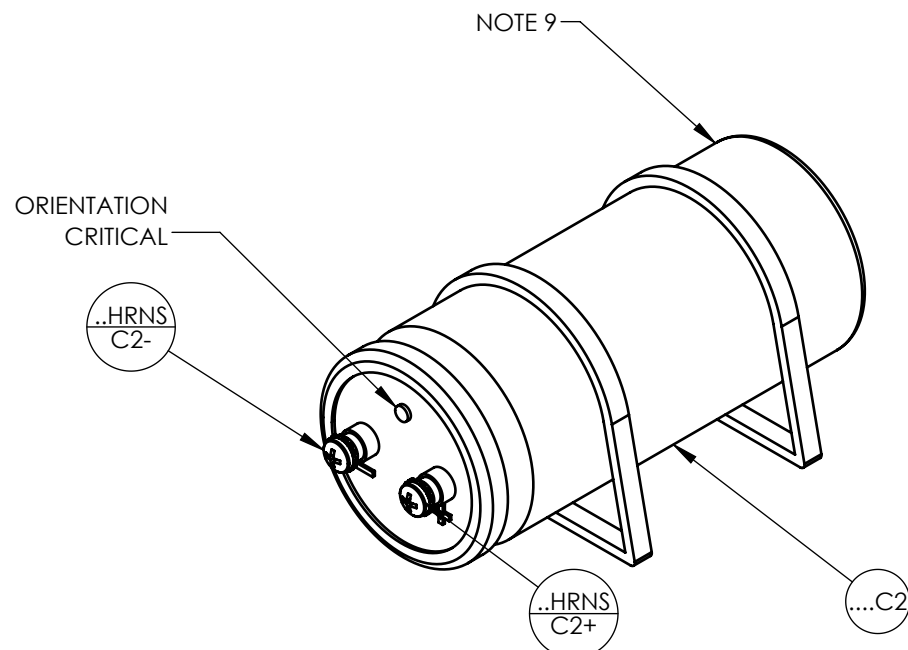

ISO VIEW

- REPLACEMENT KIT
PART NUMBERS
- EJ5312-02.
 - EJ5312-03.
 - EJ5312-04.
 - EJ5312-05.
 - EJ5312-12.
 - EJ5312-13.
 - EJ5312-15.
 - EJ5312-17.

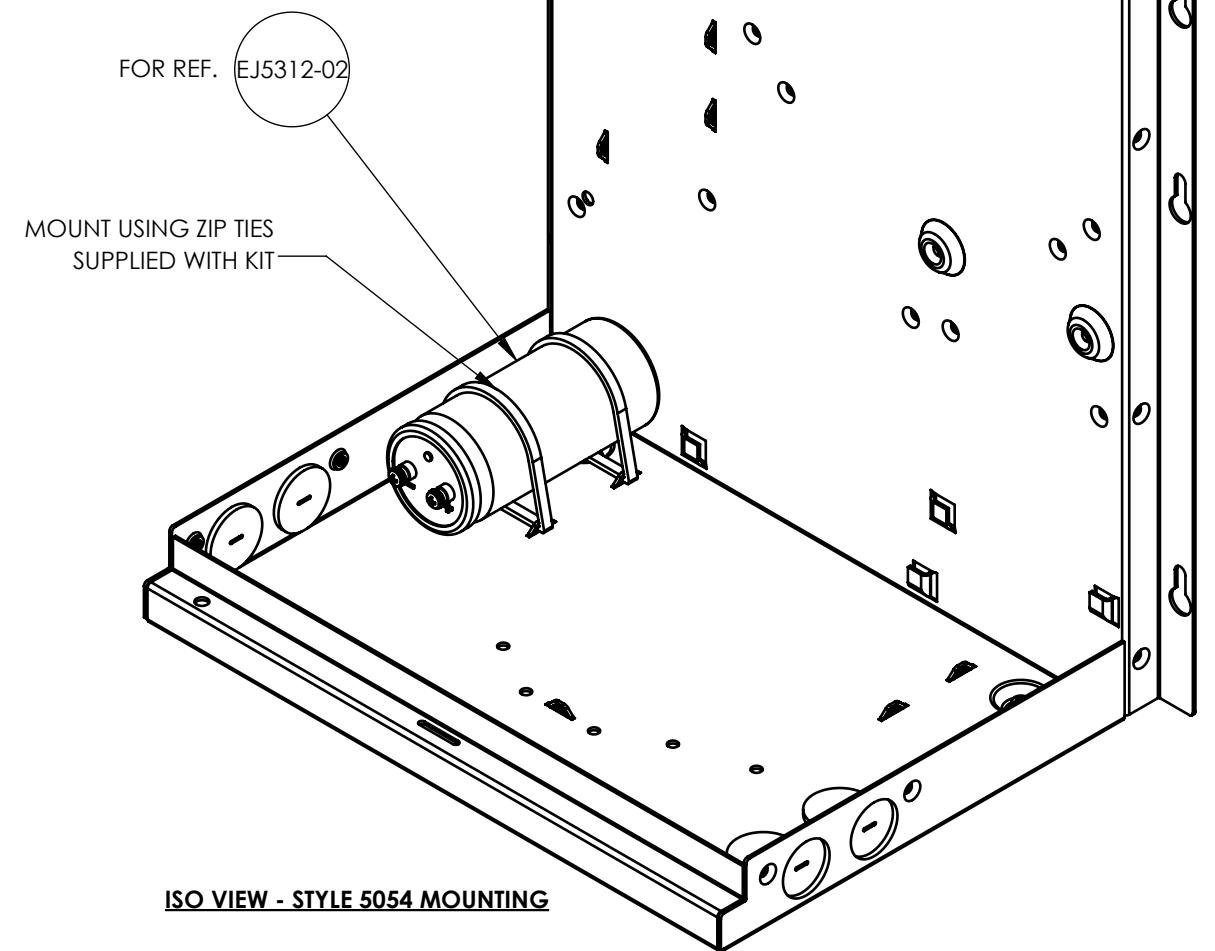

ISO VIEW - STYLE 5054 MOUNTING

REV. 0	DRN BY	CHK BY	APP BY	DATE 4/29/2022	DRN BY <i>KJB</i>	DATE: 4/5/2022	TITLE Atevo Service Instructions Eliminator Capacitor Installation 1Ø Style-5054	
DESCRIPTION Initial Release				CHK BY <i>MS</i>	DATE: 4/29/2022	UNLESS OTHERWISE SPECIFIED ALL DIMENSIONS FOLLOW THE ANSI SYSTEM IPS (INCHES-POUNDS & SECONDS) TOLERANCES ARE: FRAC. ±1/64, DEC. ±0.15, ANG ±.25°		
				APP BY <i>MCR</i>	DATE: 4/29/2022			
PROPRIETARY AND CONFIDENTIAL NOTICE ANY REPRODUCTION, PARTIAL OR AS A WHOLE OF THIS DOCUMENT WITHOUT THE WRITTEN PERMISSION OF HINDLE POWER, INC IS STRICTLY PROHIBITED.						SCALE 1:2		DWG No JD5078-02
							REV 0	SHEET 1 OF 1