

SYM	STANDARD COMPONENT DESCRIPTION
A1	MAIN CONTROL PC BOARD
A2	POWER BOARD
A6	RECTIFIER ASSEMBLY
A9	MOV PC BOARD
C1	FILTER CAPACITOR
CB1	AC INPUT CIRCUIT BREAKER (CD2)
CB2	DC OUTPUT CIRCUIT BREAKER (CD2)
AUXCB2	DC CKT BKR (CB2) AUXILIARY CONTACTS
L1	MAIN INDUCTOR
L2	FILTER INDUCTOR
R9	FILTER CAP BLEED RESISTOR
T1	POWER TRANSFORMER

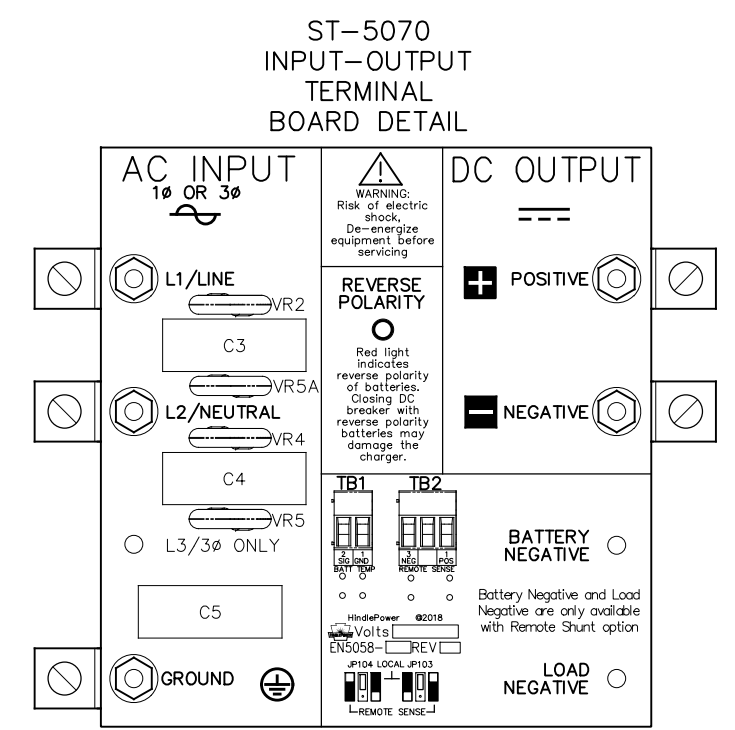
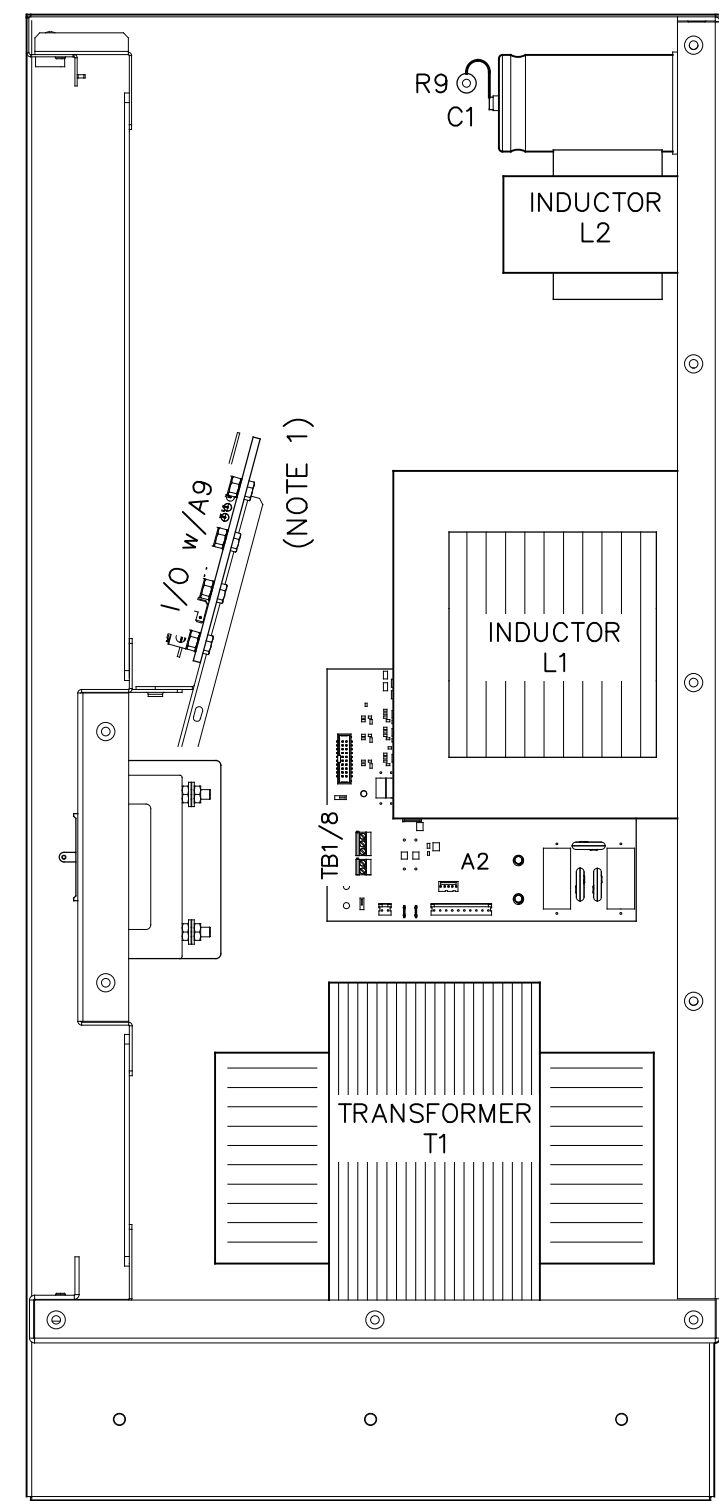
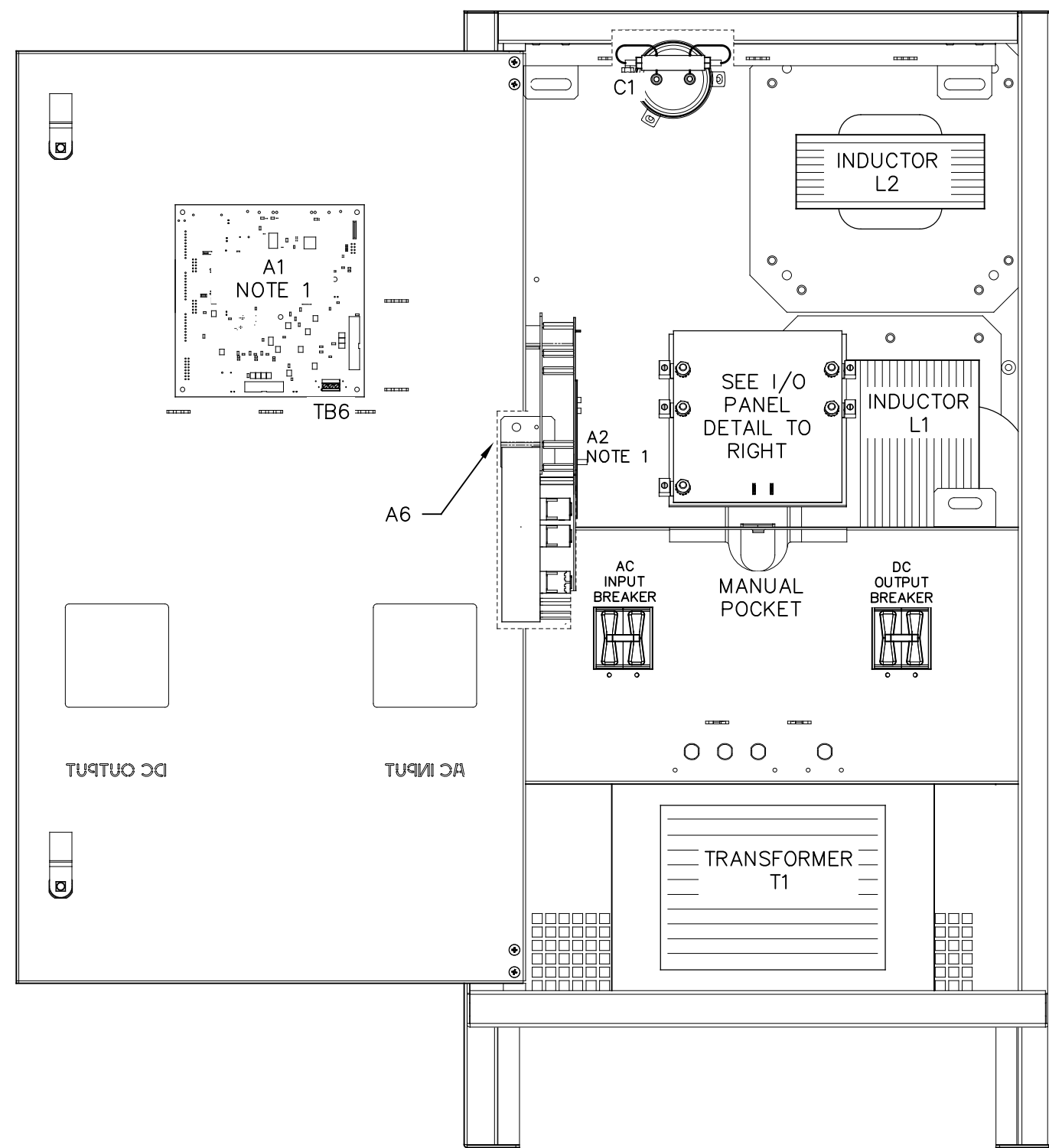

I/O TERMINAL	DESCRIPTION - TYPE	CONNECTION
I/O (+/-)	POS/NEG OUTPUT TERMINALS - CU-ALUMINUM COMPRESSION LUG	#14-1/0 AWG
GND LUG	USER GROUND TERMINAL - CU-ALUMINUM COMPRESSION LUG	#14-1/0 AWG
I/O (L1/L2)	AC INPUT TERMINALS - CU-ALUMINUM COMPRESSION LUG	#14-1/0 AWG
(A2) TB1	POS/NEG REMOTE SENSE TERMS (A2) - SOLDERLESS COMP SCREW	#22-14 AWG
(A2) TB8	TEMPCO PROBE (A10) TERM BLK - SOLDERLESS COMP SCREW	#22-14 AWG
(A1) TB6	SUMMARY ALARM TERMINAL BLOCK (A1) - SLDRLESS COMP SCREW	#22-14 AWG

NOTES:
 1. FOR DETAIL VIEWS OF ALL PC BOARDS (A1, A2, etc.) SEE DRAWING JE5313 - 00, 20, 30.

REV. C	DRN BY KJB	CHK BY MCR	APP BY MCR	DATE 6/28/2021	DRN BY KJB	DATE: 2/7/2020
DESCRIPTION: STANDARD DRAWINGS.					CHK BY MCR	DATE: 2/7/2020
					APP BY RDB	DATE: 2/7/2020

TITLE: ATEVO BATTERY CHARGER INTERNAL COMPONENT LAYOUT: STYLE-5070 FOR CHARGERS AT 75-100ADC			
B	SCALE: NTS	DWG No: JE5310-20	REV: B SHEET: 1 OF 1